



ARTUBE software for Lasertube systems developed by ADIGE on the basis of its applicative experience

New Artube software

Much too often, when talking about laser cutting machines and systems, the software that programs, controls and manages them is taken for granted. That is, all specific functions that are **developed so that the machine can be integrated in the production process** are left aside. Whereas, they are often the key features when choosing a system. In a market that is increasingly more uniform and competitive as regards technology, it is, in fact, the software that makes the difference and qualifies the production systems more and more, including those for tube laser cutting.

To confirm its technological leadership in the sector once again, ADIGE has recently fine tuned ARTUBE, a **new software** designed ad hoc for lines of the Lasertube systems, developed specifically for processing tubes.

And from observing the **hundreds of applications** used day after day, the world over and in the most varied of production sectors, ARTUBE was developed, **anticipating customer requirements** and offering **new functionalities**.

Projects and prototypes in less time

ARTUBE helps to **design, plan and manage** the production of **tubular pieces** on laser cutting machines. The main advantages compared to the previous generation are even easier use and more **ample libraries** with preset processing that can also be **customised**. In this way, users can materialise **the idea into the finished product** in just a few minutes without requiring specific skills or ex-

pert personnel.

This means a **vertical reduction** in designing and prototyping times, thereby reducing the time to market new products to the minimum indispensable; a benefit that adds up to significant savings, with the advantage of added value.

Important additional functions are:

- The possibility of importing files in **step, iges** and **xt** format, of modifying them and allowing CAM processing, without having to design the piece from scratch again;
- The management of **special or particularly complex sections** so that even unusual tubes can

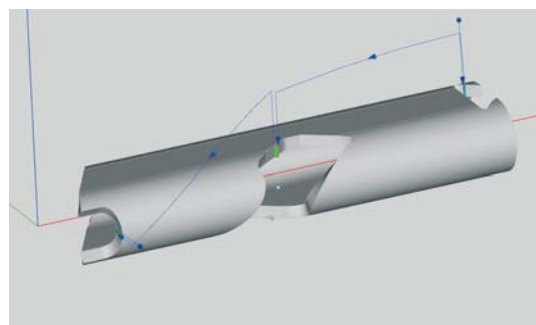
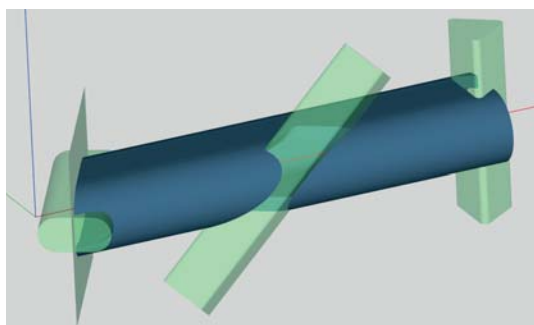
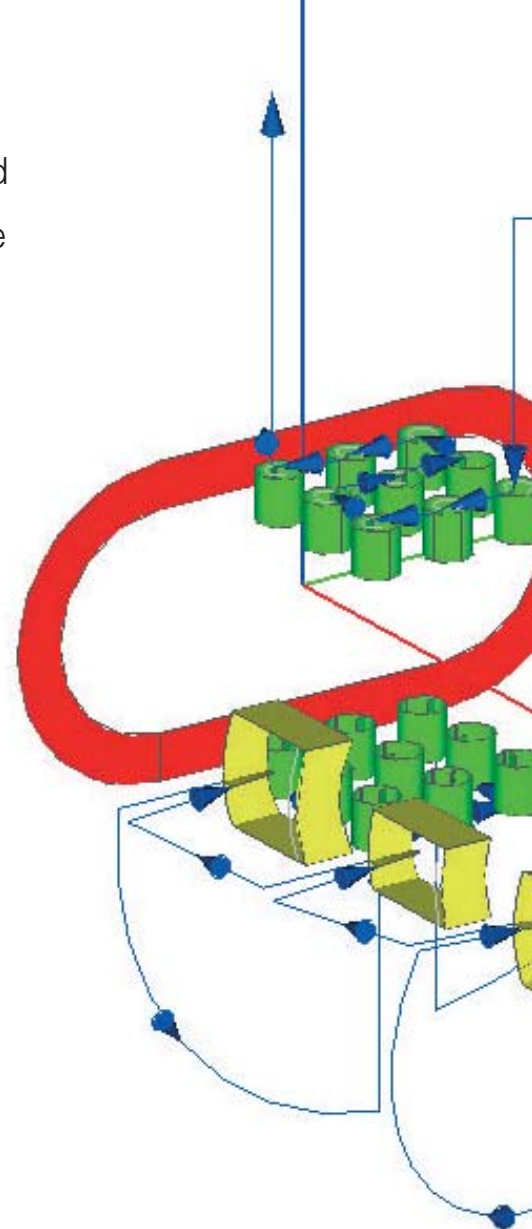

the functions, the **automatic end forming**, of all the intersections of various components, is worthy of mention, likewise the management of coupling methods and automatic development of parametric fittings. These are all **functions that help the programmer** to concentrate on the functional technical choices and not in the technical aspects of programming each frame component. CIM: a specially designed software for **remote production management** to process customer orders (by priority, due date and quantity), to effect **nesting in order to optimise production**, to have a control over the entire in-line production means with production balances and historical file.

ADIGE SPA

Via per Barco, 11
38056 Levico Terme (TN) Italy
tel. +39 0461 729000
fax +39 0461 701410
E-mail: vendite@adige.it

- be cut;
- Automatic application of **optimum cutting parameters** to guarantee high yield at all times and high production efficiency
- The automatic generation of **cutting strategies** to optimise the cutting route and associated cycle time;
- To create cutting programs for open profiles as well and not only tubes.

An even more complete package

The focus placed by ADIGE on the importance of software has been confirmed by the fact that two other main solutions can be added to AR-TUBE to complete the tube processing package. **ASSEMBLER: CAD/CAM parametric and 3D** software to design complex tubular structures and frames using very little data to start with. Among

